

# CARBIDE RODS

## Round Blanks

**KXF**  
Micrograin Carbide  
0,7 $\mu$ , 10% Cobalt  
**Tolerance**  
h6, ground and polished

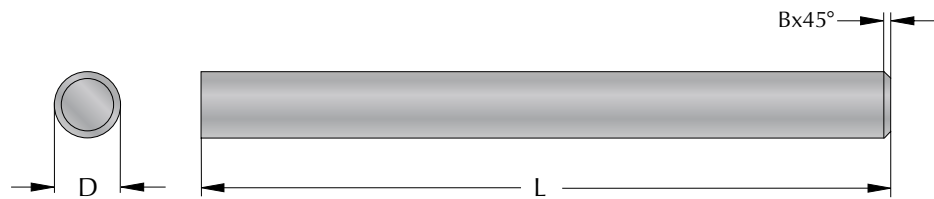

D mm	L mm	B mm	Part Number
3,0	39	0,3	Ø3X39_KXF
3,0	100	0,3	Ø3X100_KXF
3,0	320	0,3	Ø3X320_KXF
4,0	50	0,4	Ø4X50_KXF
4,0	100	0,4	Ø4X100_KXF
4,0	320	0,4	Ø4X320_KXF
5,0	100	0,4	Ø5X100_KXF
5,0	320	0,4	Ø5X320_KXF
6,0	63	0,4	Ø6X63_KXF
6,0	76	0,4	Ø6X76_KXF
6,0	100	0,4	Ø6X100_KXF
6,0	320	0,4	Ø6X320_KXF
8,0	63	0,5	Ø8X63_KXF
8,0	76	0,5	Ø8X76_KXF
8,0	100	0,5	Ø8X100_KXF
8,0	320	0,5	Ø8X320_KXF
10,0	76	0,5	Ø10X76_KXF
10,0	100	0,5	Ø10X100_KXF
10,0	320	0,5	Ø10X320_KXF
12,0	83	0,5	Ø12X83_KXF
12,0	100	0,5	Ø12X100_KXF
12,0	320	0,5	Ø12X320_KXF
14,0	89	0,8	Ø14X89_KXF
14,0	100	0,8	Ø14X100_KXF
14,0	320	0,8	Ø14X320_KXF
16,0	89	0,8	Ø16X89_KXF
16,0	100	0,8	Ø16X100_KXF
16,0	120	0,8	Ø16X120_KXF
16,0	320	0,8	Ø16X320_KXF
18,0	100	0,8	Ø18X100_KXF
18,0	130	0,8	Ø18X130_KFX
18,0	320	0,8	Ø18X320_KXF
20,0	100	1,0	Ø20X100_KXF
20,0	120	1,0	Ø20X120_KXF
20,0	150	1,0	Ø20X150_KXF
20,0	320	1,0	Ø20X320_KXF
25,0	100	1,0	Ø25X100_KXF
25,0	120	1,0	Ø25X120_KXF
25,0	130	1,0	Ø25X130_KXF
25,0	150	1,0	Ø25X150_KXF
25,0	320	1,0	Ø25X320_KXF
32,0	150	1,0	Ø32X150_KXF
32,0	320	1,0	Ø32X320_KXF
40,0	170	1,0	Ø40X170_KXF

# CARBIDE RODS

## with Internal Coolant

**KXF**  
Micrograin Carbide  
0,7 $\mu$ , 10% Cobalt  
**Tolerance**  
h6, ground and polished

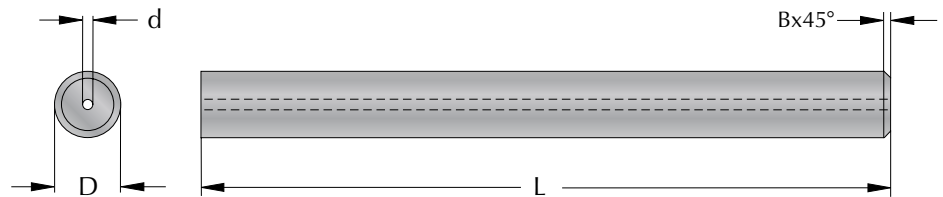

D mm	L mm	d mm	B mm	Part Number
4	50	0,6	0,4	Ø4X50Ø0.6_KXF
6	63	1	0,4	Ø6X63Ø1_KXF
8	76	1,3	0,5	Ø8X76Ø1.3_KXF
10	100	2	0,5	Ø10X100Ø2_KXF
12	100	2	0,5	Ø12X100Ø2_KXF
14	100	2	0,8	Ø14X100Ø2_KXF
16	120	3	0,8	Ø16X120Ø3_KXF
20	150	3	1,0	Ø20X150Ø3_KXF

## with Internal Radial Coolant

**KXF**  
Micrograin Carbide  
0,7 $\mu$ , 10% Cobalt  
**Tolerance**  
h6, ground and polished

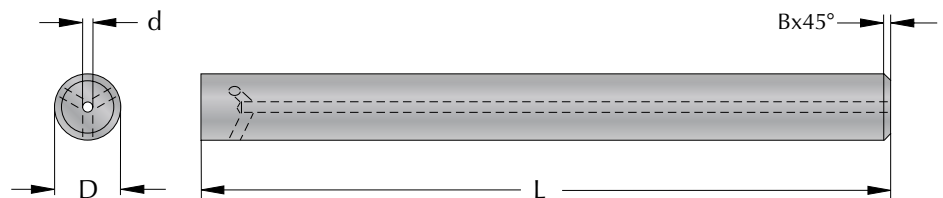

D mm	L mm	d mm	No. of holes	B mm	Part Number
6	76	1	3	0,5	Ø6X76Ø1C_KXF
8	76	1,2	3	1,0	Ø8X76Ø1.2C_KXF
8	76	1,2	4	1,0	Ø8X76Ø1.2D_KXF
10	100	1,2	3	1,0	Ø10X100Ø1.2C_KXF
10	100	1,2	4	1,0	Ø10X100Ø1.2D_KXF
12	100	1,5	4	1,0	Ø12X100Ø1.5D_KXF
16	100	1,5	4	1,5	Ø16X100Ø1.5D_KXF
16	100	1,5	5	1,5	Ø16X100Ø1.5E_KXF

■ SmiCut supply rectangular carbide rods