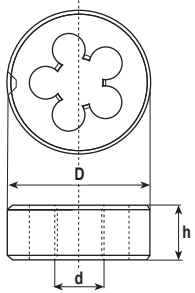
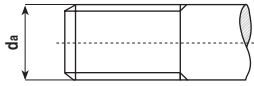

Codice Articolo

FN

Tol
Mat

NEUTRO

medium

HSS

da	mm	d x p	D	h	
				N	
1.54	1.59	W 1/16 - 60	16	5	65,74
2.33	2.38	W 3/32 - 48	20	5	49,31
3.12	3.17	W 1/8 - 40	16	5	34,75
			20	5	32,87
3.82	3.97	W 5/32 - 32	20	5	34,04
			25	7	
4.61	4.76	W 3/16 - 24	20	5	34,04
			25	7	
5.41	5.56	W 7/32 - 24	20	7	37,10
6.20	6.35	W 1/4 - 20	20	7	32,39
			25	9	37,10
6.99	7.14	W 9/32 - 20	25	9	58,70
7.79	7.94	W 5/16 - 18	25	9	36,62
9.38	9.53	W 3/8 - 16	30	11	41,56
			38	10	
10.89	11.11	W 7/16 - 14	30	11	44,60
			38	14	
12.52	12.70	W 1/2 - 12	38	14	54,47
14.11	14.29	W 9/16 - 12	38	14	58,70
15.7	15.88	W 5/8 - 11	38	14	74,65
			45	18	72,77
16.98	17.46	W 11/16 - 11	45	18	
18.87	19.05	W 3/4 - 10	45	18	77,47
20.18	20.36	W 13/16 - 10	45	18	
22	22.23	W 7/8 - 9	50	18	
			50	18	
25.2	25.4	W 1" - 8	55	18	103,30
28.38	28.58	W 1" 1/8 - 7	65	25	187,82
31.15	31.75	W 1" 1/4 - 7	65	25	183,12
34.28	34.93	W 1" 3/8 - 6	65	25	178,43
37.47	38.10	W 1" 1/2 - 6	75	30	269,98
44.11	44.45	W 1" 3/4 - 5	90	36	422,59
50.43	50.80	W 2" - 4.5	90	36	434,32